

Potters Bar & District
Historical Society

P
B

Regd. Charity No.299475

The Newsletter

January 1991.

Vol.7 No.2

Wylyyotts Museum and
Local History Centre

A Home at last !!

Almost the first action of the first officers of the Society was to produce a report on the need for a museum in Potters Bar - the date was 1960. Now their request has become a reality it is up to us to ensure the Society is able to make full use of the new facility.

THE MUSEUM WILL OPEN FROM THE 15th January, 1991.

TUESDAYS, WEDNESDAYS and SATURDAYS 2.30 - 4.30.

MORE VOLUNTEERS TO
STEWARDS ARE REQUIRED TO
BUILD UP A TEAM, CONTACT
WE WOULD LIKE TO OPEN ON
ANOTHER DAY.
B. WARREN

2 Where to find us:-

a) MEETINGS

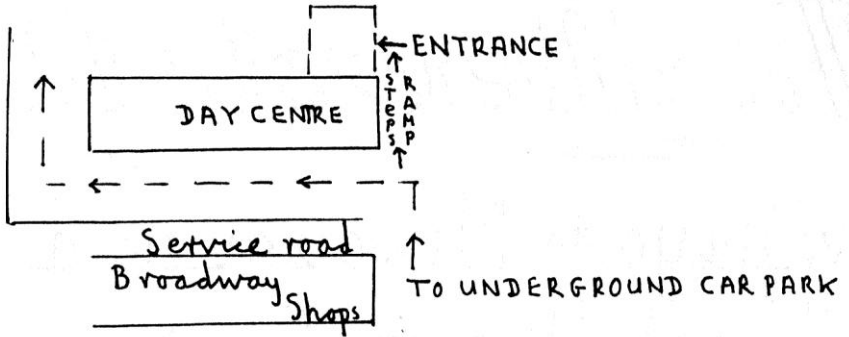

THE BROADWAY

b) Museum (FLOOR ABOVE DAY CENTRE)

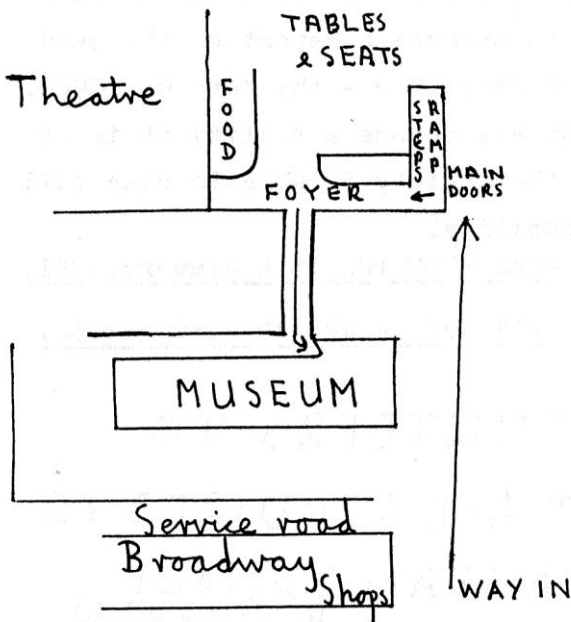

THE BROADWAY

SPRING LECTURE PROGRAMME - Monthly MeetingsTHURSDAY 31 JANUARY

'Capel Manor' by Mr.J.Edwards.

The speaker retired as librarian at Cheshunt several years ago and is well-known for his four books of photographs entitled "Cheshunt Past". He has given talks to various organisations for many years.

In 1985, the speaker was asked to produce an illustrated booklet on "Capel Manor". The talk will deal with the research involved and the past history of the site, buildings and former owners. It will be illustrated with slides.

MONDAY FEBRUARY 25th

'Prehistory North of the Thames' by
Dr.N.J.Merriman.

Dr.Nick Merriman is an Assistant Keeper at the Dept. of Prehistoric and Roman Antiquities, at The Museum of London.

The talk will cover the half million years between the earliest human occupation of the Thames Valley, to the Roman conquest. At the beginning of this period, the Thames valley itself is being formed by glacial action. For over 400,000 years the area experiences a succession of cold and warm periods during which time there is extensive human occupation. Highlights include the earliest human skull from Britain and elephants in Trafalgar Square! At the end of the Ice Age there is permanent occupation by hunter-gatherers, followed at about 4,000 BC by the development of settled farming communities. Recent excavations have revealed important evidence of their ritual monuments.

Settlement rises to a peak around 800 BC, after which the area sees small-scale farming in the landscape. The Thames remains as a focus of rituals, but by the time of the Roman invasion the centres of power are away from the river to the north and south.

FRIDAY 22 MARCH

'The History of Bentley Heath' by Mr.B.Warren.

The Wrotham Park estate village of the 19thC will be outlined first. What happened before then will show the movement of the settlement in the 18thC. The talk will conclude by posing problems of the medieval settlement, using previously unknown information, much of which has been discovered in the last year.

ALL MEETINGS AT THE SIXTY PLUS DAY CENTRE,
WYLLYOTTS MANOR (See map) 8pm

If you should require a lift please contact a member of the committee and they will do their best to make the arrangements.

REMINDER:- MONDAY 29th April Annual General Meeting

BARNET PRESS - NEW ADDRESS:-

North London & Herts Newspapers,
10, Silver Street,
Enfield,
EN1 3EQ

MEMBERS' NEWS

It is with regret that one records the passing of Mrs.V.Harding, a member since 1976. Only recently had she moved from Auckland Road to Aberdale Gdns., where she was very happy in her new abode. Also, she was looking forward to celebrating her 80th birthday. She was a regular attender at the monthly meetings.

Stan Reddington, her neighbour for 35yrs. and Cyril Overend represented the Society at the funeral, on the 7th January.

The Society expresses its condolences to her family and friends.

A warm welcome is expressed to the following new members:- Mrs.Joan Slow, Mrs.C.M.Woodward, Mrs.Joy Sims and Mrs.J.Wilkerson. It is hoped that they will find great benefit from belonging to the Society.

<u>REMINDER</u>	<u>ONLY THOSE MEMBERS WHO HAVE PAID THEIR SUBSCRIPTIONS WILL RECEIVE THEIR COPY OF THE JOURNAL.</u>
-----------------	---

WINTER PROGRAMME REPORTSOCTOBER The Church in Domesday England Mrs.M.Lewis.

The speaker showed a complete command of her subject as she traced the reign of King William from his days as, Duke of Normandy, to 1066, and his period as the 'Conqueror. It was shown how the Church was used to control the state and order was maintained throughout the kingdom. Control of the Church was effected by the skilful replacement of the Anglo-Saxon Bishops by those who owed allegiance to the crown. Thus through these Norman family connections was ensured a stable and obedient church.

Mrs.Muriel Brittain, the Society's President, voiced the thanks of those present to Marilyn Lewis, for a fascinating lecture given without the use of slides.

NOVEMBER Southgate Before 1914 by Mr.G.Dalling.

This was the last talk to be given at Oakmere House and Graham Dalling, the local history officer for Enfield, outlined the gradual spread of transport, from the horse buses, the electric tram, to the first application for a motor garage in the area in 1904.

He said it cost 4d(2p) from Palmers Green to Tottenham Court Road on the the tram.

Southgate separated from Edmonton in 1881 and the population trebled in 20 years from 1891. The newcomers used the Great Northern Railway to get to work.

Southgate had one of the lowest child mortality rates which proved it was a healthy residential suburb. However, the people displayed a social exclusiveness of a high order and some of the newcomers lived beyond their means, incurring bad debts with local tradesmen.

Palmers Green and Winchmore Hill developed, but Old Southgate and Cockfosters remained rural and the co-existence of the urban and rural sides remained for another twenty years.

Terry Goulding thanked the speaker for his talk about Southgate, an area which was well known to some of the audience.

Not only was this the first talk at the new Wyllyotts Centre but there was a link between last month's speaker and Mr.S.Beadle - the latter had taught Mr.G.Dalling Geography many years ago. Since retiring Sid Beadle had taken the study of bricks in the area as a hobby.

In a very interesting and effective way he traced the history of brick and tile manufacture starting with the Romans. He mentioned the IstC tile kiln in Parkfield, excavated in 1953/54, of which some material can now be seen in the Museum at Wyllyotts.

With the ending of the Roman occupation some 900 years went by before bricks were again made, this time by clerics who arrived from the Low Countries bringing the art of brick-making with them and using clay from the Lea Valley. A slide was shown of the large bricks in the Gatehouse at Waltham Abbey, which can still be viewed today.

By Tudor times brick-making had improved to a form not unlike that used today. The speaker then used a painting of a brick works in Edmonton to illustrate the processes of brickmaking. There were only three known paintings of brickmaking.

Cyril Overend expressed the Society's thanks to Sid Beadle for an illustrated talk which was much appreciated by the members.

THANKS

Marian Baker and Barbara Clinton are thanked for supplying copies of Hertfordshire Countryside, which were asked for in the last Newsletter.

RESEARCH

- a) It does occur from time to time that documents, articles need to be copied out. This requires time and can be done at home. If you feel you could do this, as requested, then contact Brian Warren.
- b) The coloured maps which the Society sells have to be coloured. If you have a steady hand and would like to join a small group which undertakes this task, again contact Brian Warren.

KEEPING YOUR EYES OPEN :- UPDATE ON CLAY PIPES

Previous articles occurred in, 'The Newsletter' vol.3 no. and Vol.3. and Vol.3 No.3. In those articles were recorded the finds of clay pipes at Canada Life(Tilbury dig 1963), Nos. 44 and 93 The Walk.

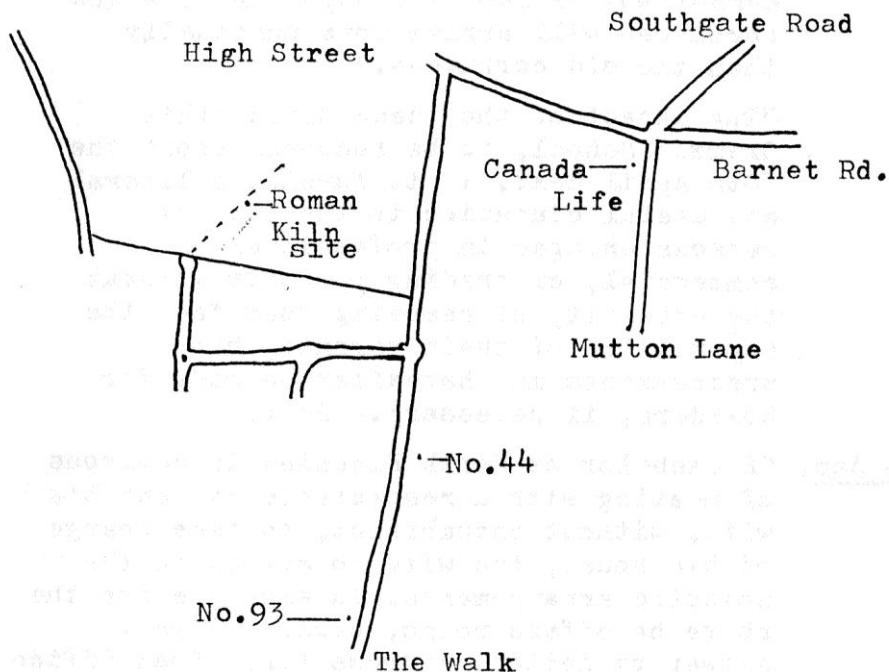

In obtaining the pottery, etc. from Barnet Museum, which was originally excavated at the 1st century Roman Kiln site, in Parkfield, the

following clay pipes were noted:-

- a) cI710-I780 Oswald type 9b No initials.
- b) cI710-I780 Oswald type 9b Maker's initial indecipherable.
- c) Lighter version of a & b with longer spur - Initials I.S.
- d) As in c) except initials ?A.S.

Also found at the same level but not associated with the pipes was a George III $\frac{1}{2}$ d, 1760-1820.

Perhaps the Georgian coin was associated with the Georgian Parkfield House.

1875

23rd Jan. "A large number of new carriages have been used during the past week by the Great Northern Railway. The seats in the third class are cushioned, and the first and second classes are also improved. We cannot but express the hope that the new carriages will arrive more punctually than the old carriages."

"The object of the Queen Elizabeth's Grammar School, to be reopened about the 20th April next, is to furnish a liberal and useful education to the sons of persons engaged in professional, commercial, or trading pursuits without the necessity of removing them from the supervision of their parents, but arrangements may hereafter be made for boarders, if necessary.- Advt."

30th Jan. "A bachelor at North Finchley is desirous of meeting with a respectable man and his wife, without encumbrance, to take charge of his house, the wife to attend to the domestic arrangements. In exchange for the above he offers rooms, coal, and gas. Answer by letter, address A.B., Post Office North Finchley.-Advt."

"Almost every available seat in the Potters Bar Baptist Church was occupied at the anniversary meeting on Monday, and the meeting was an unprecedented success. Mr. Pilling reported that the congregation had increased, that the sympathy and devotion of the people had become greater, and that there was a credit balance at the bank."

6th Feb. "A.O." writes:- "The reverend gentleman at Potters Bar anniversary service gave a very cheering account of the spiritual work going on, but he omitted the statistics. Will he kindly favour with same?"

13th Feb. "A deputation waited upon the directors of the Great Northern Railway on Tuesday. Among the speakers was Mr.R.W.Wilkinson, who suggested that if the company would run fast trains to Barnet, stopping at alternate stations, it would be a great inducement for persons to live on the line." (Sounds a dangerous existence - Ed. Newsletter).

BOOKS

A Companion to Local History Research by John Campbell-Kease.

Alpha Books A. & C.Black £15.95 1989

ISBN 0 7136 31457

Batsford Local History Series - Maps for Local History by Brian Paul Hindle 1988

ISBN 0 7134 5584 5 Pbk

QUOTE:- "As always, maps can only be used as evidence when they do show the existence of a feature; the omission of a feature does not mean it was not there."

CORRECTION THE NEWSLETTER Sept.1990 p12

The plaque to the 7th son of Banister Fletcher in the Harrow School Chapel refers to the architect. He did not design the Chapel, that was the work of George Gilbert Scott, as was the library.

The curator of the museum has a file of Harrow artists which includes Churchill, Alexander, Cecil Beaton, Victor Pasmore, Piers de Laszlo, Rodney Burn and many others.

THE LOCAL HISTORIAN August 1990 Vol.20 No3

This edition contains two articles which might be of interest to some of our members:-

- a) Researching the local history of cinema by
Ned Williams
- b) The national inventory of war memorials by
Catherine Moriarty.

Are you doing anything on the
first Tuesday in the month?

Why not come to recitals at
St Mary's in The Walk.

12.00 - 2.00 p.m. PLOUGHMAN'S LUNCH
90p

12.30 - 1.10 p.m. RECITAL (no charge)

5th February Terence Atkins.
Organist at Barnet Church.

5th March Mount Grace School Choir.

2nd April Richard Bond, former organist at
St. Mary's in the 1970s, now
organist at St. Michael's, St.
Albans.

About half-a-dozen members of the Historical
Society already go, so why not join them.

MUSIC — FOOD — FRIENDS
WHAT MORE IS REQUIRED

In this edition the late Malcolm Tomkins wrote an article about a seventeenth century lady who rode some 3,000 miles on horseback round England. Her name was Celia Fiennes -not again I can hear you all saying.

Following up this lead I consulted, 'The Illustrated Journeys of Celia Fiennes 1685-1712' edited by Christopher Morris, at The Guildhall.

Celia was born June 7th 1662 and was a Nonconformist. "Celia, however, has her main establishment at Barnet, although her house there seems to have been let. She may well be the 'Mistress Fiennes' who endowed the Nonconformist chapel at Wood Street, Barnet in 1709 (W.Urwick, Nonconformity in Hertfordshire p270), she has already given them a table cloth and pewter plate for the Communion."

On p118 one reads, " Thence we came to Barnet and seemes to be a very sharpe aire, its a large place and the houses are made commodious to entertain the Company that comes to drink the waters, which certainly if they be at the paines to go once and see would have but little stomach to drink them; the well is alarge place walled in 8 square, its at least two yards over and built 2 or 3 yards up from the water and over its lattices of wood round to looke down into it and so covered like a house above, below are staires down to a doore to go in to dip the water there; I stood at the lowest step above the water to look into it; its full of leaves and dirt and every tyme they dip it troubles the water, not but what they take up and let stand looks clear but I could not taste it; its very deep and not done at the bottom with a bason as Tunbridg, neither can you see the bottom, so that it appears not to be a quick spring as Tunbridg or the Spaw or Hamstead waters, which have all fire stone basons in which you see the spring's bubble up as fast, and by a pipe runs off as clear and fast: it more resembles Epsom for which reason I dislike that; thence to Highgate, thence to London." date 1697.

THE NEWSLETTER It is hoped that members have noticed the improved clarity of the type in the last two editions. This is due to Dan.Ruge-Cope using the facilities at St.Mary's. For which we are very grateful - though it costs us more!

OCCASIONAL PAPERS - No.3



DARKES LANE ON A SUMMER SUNDAY IN 1953

GROWING UP IN POTTERS BAR 1946 - 1954

by M. DRINNAN.